



# ENTUNE™

Topical 

## Full-Spectrum Hemp-Derived CBD Oil Squares (16.5 g each)

**Ingredients:** White Willow Bark Extract, Cat's Claw Extract, Hemp (*Cannabis sativa*) CBD Oil (< 0.3% THC Certified), Water-Soluble Hemp (*Cannabis sativa*) CBD Powder (< 0.3% THC Certified), CoQ10, Black Pepper Extract, Dermal Approved Acrylic Co-Polymer Adhesive.

The endocannabinoid system is a group of enzymes, receptors, and molecules that helps regulate myriad physiological functions. It has been called the "master regulator" of the human body. Cannabidiol (CBD) helps modulate receptors found throughout the body that are associated with multiple cellular and physiological responses to hormones, neurotransmitters, and environmental stimulants. Through this interaction with cell receptors, CBD tunes the endocannabinoid system to promote calm feelings, aid normal cognitive function, encourage a positive mood, support restful sleep, and quiet everyday aches, leading to improved overall well-being.



GLUTEN FREE



SOY FREE



VEGAN



### KEY BENEFITS

- Helps support multiple key physiological systems to promote a general sense of well-being
- Dual delivery system provides fast and sustained distribution of CBD for 24 hours
- Helps encourage calm, collected feelings during periods of stress or nervousness
- Influences the endocannabinoid system for fast-acting comfort of muscles and joints
- Helps promote restful sleep
- Calms an overactive mind to encourage greater focus on the present
- Aids normal immune and nervous system responses
- CBD combined with CoQ10 helps support natural mitochondrial homeostasis to calm the nervous system
- Cat's claw and willow bark help to quiet and soothe the musculoskeletal system and support a normal inflammatory response and helps support immune equilibrium

### DID YOU KNOW?

The total number of cannabinoid receptors in the body is thought to be greater than all other neuromodulatory receptors combined. All vertebrates and invertebrates have an endocannabinoid system. Physical activity can boost the endocannabinoid system. Sustained aerobic activity increases levels of anandamide (a natural cannabinoid produced from fatty acids in the body).

### SEE THE ZIJA DIFFERENCE

Visit [zijadifference.com](http://zijadifference.com), enter the unique batch code found on your Entune packaging, and gain access to the tests performed on the product and the results.

### SUGGESTED USES

- Apply one (1) transdermal square to the affected area daily and leave on for up to 24 hours.
- For general well-being, apply to the underside of the upper arm, inner thigh, or the spine near the base of the neck and leave on for up to 24 hours. Periodically rotate application site.

These statements have not been evaluated by the Food and Drug Administration. This product is not intended to diagnose, treat, cure, or prevent any disease.

Caution: If pregnant, nursing, taking medication, or have a medical condition, consult your health professional before use.

Note: U.S. Farm Bill compliant (section 10113). Our Full-Spectrum (FS) Hemp CBD product meets or exceeds all federal regulations for industrial hemp, including THC content (< 0.3%). This product has not been systematically studied for effects on various types of drug testing.

## ADDITIONAL SUGGESTED USES:

Essential oils can provide a variety of benefits when used topically or orally. At Améo, we make sure to source the most pure botanicals available to provide you with the most advantageous experience possible. Enhance your Entune experience by adding your favorite topical Améo Essential Oils to your Square or taking Améo Essential Oils in a capsule while wearing a Square. Follow the instructions to the right to ensure the best results when pairing Entune CBD Squares with topical essential oils.

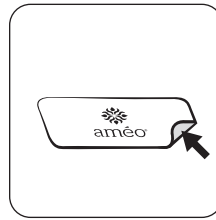

For maximum results, add the Améo Essential Oil to the adhesive, sticky side of the Square.

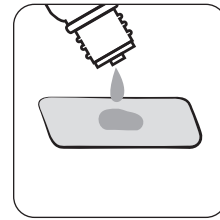

Add one to two drops of your chosen Améo essential oil to the center of the Square, avoiding the outer edges.

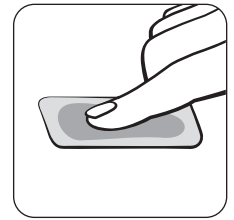

Using your index finger, gently rub the essential oil into the center of the Square and apply the Square to the skin.

- Add one (1) drop of Améo Copaiba or Black Pepper to the adhesive side of the square to provide an additional cannabinoid (beta-caryophyllene) and further support endocannabinoid system function.
- Add one (1) drop of Améo Pure Tranquility or Calming Breeze to the adhesive side of the square to enhance feelings of calm.
- Add one (1) drop of Améo True Lavender or Vetiver to the adhesive side of the square to promote restful sleep.
- Apply Améo Thera-Ease around the square after application to enhance the soothing effects for minor aches.
- Take 5 to 7 drops of Améo Copaiba in an Améo Targeted Release Veggie Cap after applying the square to help support multiple physiological systems for improved well-being.

These statements have not been evaluated by the Food and Drug Administration. This product is not intended to diagnose, treat, cure, or prevent any disease.

Caution: If pregnant, nursing, taking medication, or have a medical condition, consult your health professional before use.

Note: U.S. Farm Bill compliant (section 10113). Our Full-Spectrum (FS) Hemp CBD product meets or exceeds all federal regulations for industrial hemp, including THC content (< 0.3%). This product has not been systematically studied for effects on various types of drug testing.



©2019 Zija International, Inc. All Rights Reserved. (0219)

Entune (12 Squares) | SKU# 177383 | Whsl. \$49.95 | Retail \$66.00 | PV: 37  
Entune (30 Squares) | SKU# 177384 | Whsl. \$99.95 | Retail \$133.00 | PV: 75